

HANYANG UNIVERSITY

Fall 2018 | Admission Guideline for International students with foreign citizenship whose parents both have foreign citizenship (Undergrad & Grad) and International students including Koreans residing overseas who have completed the entire elementary, middle, high school and undergraduate education outside Korea (Grad)

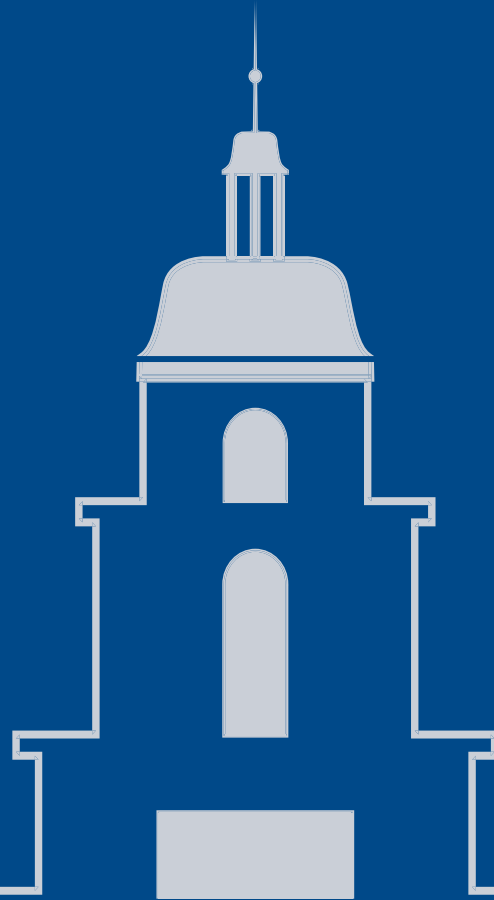

HANYANG UNIVERSITY



HANYANG UNIVERSITY

The Engine of Korea
HANYANG UNIVERSITY

QS World University Rankings(2017-2018) **155th**

30th QS Asian University Rankings (2016)
43rd Civil and Structural Engineering
86th Engineering & Technology
131st Social Sciences & Management
178th Arts & Humanities

Hanyang University is one of the top universities in South Korea and was established in 1939 as the nation's first private engineering college. Hanyang is nationally renowned for its major role in development of Korea, in the destructive aftermath of Japanese occupation and Korea War. Today, Hanyang graduates can be found in virtually every industry, many serving as executives in companies including Samsung, Hyundai, and POSCO.

Hanyang University is composed of two campuses, one in central Seoul and the other in the city of Ansan on the southern outskirts of Seoul. The **Seoul Campus** is **ranked 3rd** and the Ansan campus, referred to as the **ERICA* Campus** is **ranked 9th** in the Joong-Ang Daily Korean University Rankings. Over the years, the Seoul Campus has been rapidly transforming to maintain its status as a top university, while the ERICA Campus has been witnessing explosive growth resulting from its specialization in university-industry cooperation.

* ERICA: Education Research Industry Cluster at Ansan



Joong-Ang Daily Korean University Rankings (2017)



Joong-Ang Daily Korean University Rankings (2017)

Major Fields of Study



Engineering

Ranked **1st** by Korea Economic Daily 2017 Engineering School Assessment



International Studies

100% English track



Business Administration

AACSB accredited



Design



Communication and Social Sciences



Sports and Arts

* For more information, please visit: study.hanyang.ac.kr

Support Program for International Students



Global Information Center

OIA Provides One-Stop Service for foreign students to help their university life in Korean, Chinese and English.



Career Development Support

OIA offers career development sessions and job opening notifications for International students.



Counseling for International Students

Students are able to take psychological tests and receive 1:1 counseling about what they feel in their school life.

한글

1:1 Korean Language Lesson

OIA provides 1:1 Korean language support program for those who want to study Korean language and make Korean friends.

Internationalization



About 8,000

Number of International Students per year (2017)

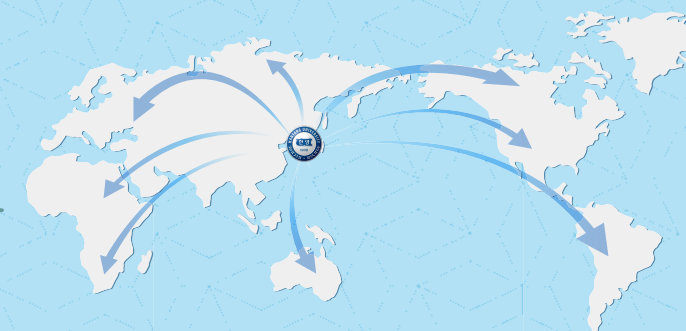

735 institutions

International Partner Universities from 74 Countries (2017)

Achievement



Hanyang University has officially received **IEQAS**(International Education Quality Assurance System) certification from the Ministry of Education for six consecutive years since 2012.



Hanyang University

Admission Guidelines for
International Students

Contents

- 05 Application Procedure
- 06 Admission Unit
 - 2018 Undergraduate Departments
 - 2018 Graduate School Departments
- 18 Application Schedule
- 19 Eligibility Requirements for Application
- 21 Required Documents
- 28 Selection Procedure
- 31 Admission Test
- 32 HYU Korean Language Proficiency Standard
- 33 Dual application for students applying for undergraduate program
- 34 Dormitories
- 35 Graduation Requirement
- 35 Admission Inquiries and Document Submission
- 36 Scholarships for International Students
- 37 Tuition Fee Chart

01

Application Procedure

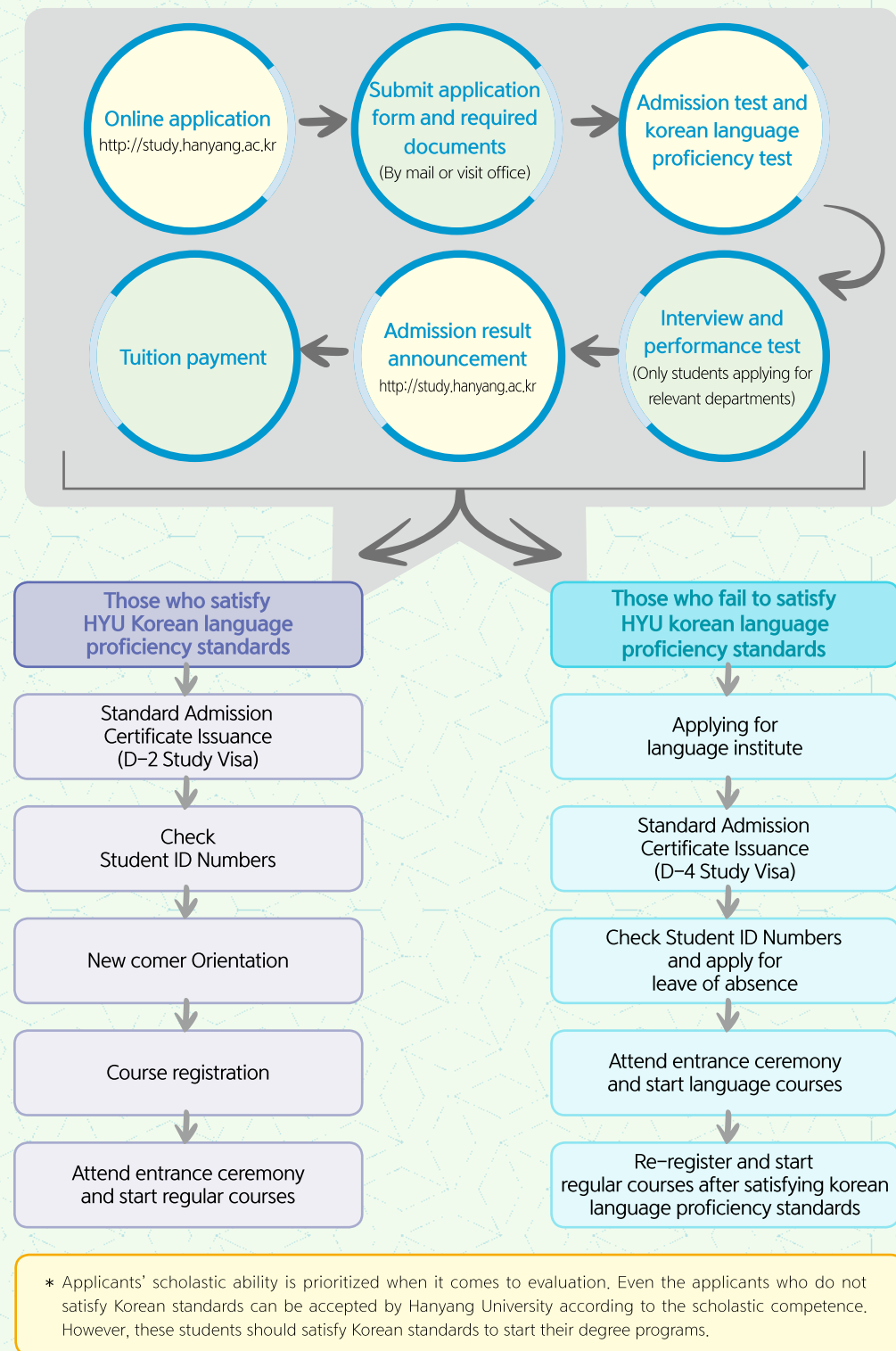

02

Admission Unit

● 2018 Undergraduate Departments

[Seoul Campus]

College/School	Department/Division	Major/Note
Engineering	Architecture (5-year program)	※ Transfer applicants cannot apply.
	Architectural Engineering (4-year program)	
	Civil and Environmental Engineering	
	Urban Planning	
	Earth Resources and Environmental Engineering	
	Electronic communication Engineering	※ Additional evaluation by Department
	Computer Software Engineering	※ Additional evaluation by Department
	Computer Science and Engineering	Computer (*Only transfer students can apply)
	Information System	
	Electrical and Biomedical Engineering	Electrical Engineering, Biomedical Engineering (Cannot change sub-majors after admission)
	Materials Science and Engineering	
	Chemical Engineering	
	Bio Engineering	
	Organic Nano Engineering	
	Energy Engineering	※ Additional evaluation by Department
	Mechanical Engineering	
	Nuclear Engineering	
	Industrial Engineering	
	Automotive Engineering	※ Additional evaluation by Department
Humanities	Korean Language and Literature	
	Chinese Language and Literature	※ Chinese students are not able to participate in Local Semester Program for fall semester of Sophomore year
	English Language and Literature	
	German Language and Literature	
	History	
Social Sciences	Philosophy	
	Political Science and Diplomacy	
	Sociology	
	Media Communication	
Natural Sciences	Tourism	
	Mathematics	
	Physics	
	Chemistry	
Policy Science	Life Science	
	Policy	
Economics and Finance	Public Administration	※ Additional evaluation by Department
	Economics and Finance	
Business Administration	Business Administration	
	Financial Management	※ Additional evaluation by Department
Human Ecology	Clothing and Textiles	
	Food and Nutrition	
	Interior Design	
Music	Voice	
	Composition	
	Piano	
	String and Wind Instrument	
	Korean Traditional Music	
Fine arts and Physical Education	Physical Education	
	Sport Industry and Management	
	Theater and Film	Film, Play directing, Acting (Cannot change sub-majors after admission)
	Dance	
International Studies	International Studies	*English track

[ERICA Campus]

College/School	Department/Division	Major/Note
Engineering	Architecture	Architecture (5 yrs.), Architectural Engineering (4 yrs.)
	Civil and Environmental Engineering	※ Civil and Environmental Plant Engineering for Transfer applicants.
	Transportation and Logistics Engineering	
	Electronics Engineering	
	Materials Chemical Engineering	
	Mechanical Engineering	※ Freshman admission only for Fall Semester
	Industrial Management Engineering	
	Bionano Engineering	
	Robot Engineering	
Computing	Computer Science	Computer Technology, Software Technology
	Media, Culture, and Design Technology	Media Technology, Culture Technology, Design Technology
Science and Convergence Technology	Applied Mathematics	
	Applied Physics	
	Molecular Biology	
	Nano-optic Electronics	※ Transfer applicants cannot apply.
	Chemistry molecular Engineering	
	Marine Science Engineering	
International Culture	Korean Language and Literature	
	Cultural Anthropology	
	Digital Culture and Contents	
	Chinese Studies	
	Japanese Studies	
	English Language and Culture	
	French Studies	
Communication and Social Sciences	Advertising and Public Relations	
	Journalism and Mass Communication	Journalism and Mass Communication and Sociology of Information Society will be combined into Information Society Media starting from 2019.
	Sociology of Information Society	
Economics and Business Administration	Economics	
	Business Administration	
Design	Jewelry Fashion Design	
	Surface Interior Design	
	Technology Product Design	
	Communication Design	
	Entertainment Design	
Sports and Arts	Sports Science	※ Transfer applicants cannot apply.
	Sports and Well being	Sports in Life, Coach Training (※ Only for Transfer applicants)
	Dance and Performing Arts	
	Applied Music	

- * International student can apply for the courses listed above.
- * Courses are subject to change and will be confirmed before semester starts. Please check the courses you wish to study prior to online application.
- * International students should decide majors carefully since they are not allowed to change majors after admission. Student must re-apply for admission to Hanyang University if he or she wants to change their majors.

[Seoul Campus]

College/Division	Department	Major	Field	Program			Note
				MA/MS	Ph.D	MA/MS – Ph.D	
Engineering Group 1	Architecture Engineering	–	Engineering	○	○	○	
	Urban Planning	–	Engineering	○	○	○	
	Earth Resources & Environmental Engineering	–	Engineering	○	○	○	
	Architecture	History, Theory and Criticism of Architecture	Engineering	○	○	○	For those who have undergraduate or graduate degrees home and abroad
	Architecture	Architectural Design I (2.5yrs)	Engineering	○	X	X	Submit art work, 5 semester, For those who have a bachelor's degree of architecture or architectural engineering home and abroad
	Architecture	Architectural Design II (1.5yrs)	Engineering	○	X	X	Submit art work, 3 semester, For those who have a bachelor's degree of 5-year architecture program home and abroad
Engineering Group 2	Electrical Engineering	–	Engineering	○	○	○	
	Electronics, Computer and Communication Engineering	–	Engineering	○	○	○	
	Biomedical Engineering	–	Engineering	○	○	○	
	Intelligent Robotics	–	Engineering (interdisciplinary courses)	○	○	○	
	Nanoscale Semiconductor Engineering	–	Engineering (interdisciplinary courses)	○	○	○	
	Information Display Engineering	–	Engineering (interdisciplinary courses)	○	○	○	
Engineering Group 3	Chemical Engineering	–	Engineering	○	○	○	
	Bioengineering	–	Engineering	○	○	○	
	Materials Science and Engineering	–	Engineering	○	○	○	
	Organic and Nano Engineering	–	Engineering	○	○	○	
	Industrial Engineering	–	Engineering	○	○	○	
Engineering Group 4	Mechanical Convergence Engineering (mce.hanyang.ac.kr)	–	Engineering	○	○	○	
	Automotive Engineering	–	Engineering	○	○	○	
	Nuclear Engineering	–	Engineering	○	○	○	
	Computer and Software Engineering	–	Engineering	○	○	○	
Engineering Group 5	Information System	–	Engineering	○	○	○	

College/Division	Department	Major	Field	Program			Note
				MA/MS	Ph.D	MA/MS – Ph.D	
Engineering Group for WCD	Civil & Environmental Engineering	–	Engineering	○	○	○	
	Energy Engineering	–	Engineering	○	○	○	
Interdisciplinary Industrial Studies	Entrepreneurship	–	Engineering (interdisciplinary courses)	○	X	X	
	Arts & Technology	–	Engineering (interdisciplinary courses)	○	X	X	Submit Artwork
	Active Aging Industry	–	Physical Science (interdisciplinary courses)	○	X	X	
Business	Business Administration	Marketing	Humanities/ Social Sciences	○	○	X	
	Business Administration	Strategic Management	Humanities/ Social Sciences	○	○	○	
	Business Administration	Management Information System	Humanities/ Social Sciences	○	○	○	
	Business Administration	Finance	Humanities/ Social Sciences	○	○	○	
	Business Administration	Operation and Service Management	Humanities/ Social Sciences	○	○	○	
	Business Administration	International Business	Humanities/ Social Sciences	○	○	○	
	Accounting	–	Humanities/ Social Sciences	○	○	X	
	Business Infomatics	–	Humanities/ Social Sciences (interdisciplinary courses)	○	○	○	
	Economics and Finance	–	Humanities/ Social Sciences	○	○	○	
	Korean Language and Literature	–	Humanities/ Social Sciences	○	○	X	
Humanities	English Language and Literature	English Literature	Humanities/ Social Sciences	○	○	○	
	English Language and Literature	English Language	Humanities/ Social Sciences	○	○	○	
	German Language and Literature	–	Humanities/ Social Sciences	○	○	○	
	Chinese Language and Literature	–	Humanities/ Social Sciences	○	○	X	
	History	–	Humanities/ Social Sciences	○	○	X	
	Philosophy	–	Humanities/ Social Sciences	○	○	X	
	Mass Media & Scenario Contents	–	Humanities/ Social Sciences (interdisciplinary courses)	○	○	○	
	Media Communication	–	Humanities/ Social Sciences	○	○	○	
	Political Science and Diplomacy	–	Humanities/ Social Sciences	○	○	○	
	Sociology	–	Humanities/ Social Sciences	○	○	○	
Social Science	Tourism	–	Humanities/ Social Sciences	○	○	○	

02

Admission Unit

● 2018 Graduate School Departments

[Seoul Campus]

College/Division	Department	Major	Field	Program			Note
				MA/ MS	Ph.D	MA/MS - Ph.D	
Education	English Education	-	Humanities/ Social Sciences	○	○	○	
	Korean Education	-	Humanities/ Social Sciences	○	○	X	
	Education	-	Humanities/ Social Sciences	○	○	X	
	Educational Technology	-	Humanities/ Social Sciences	○	○	X	
	Museum Education	-	Humanities/ Social Sciences (interdisciplinary courses)	○	○	X	
	Lifelong Learning	-	Humanities/ Social Sciences (interdisciplinary courses)	○	○	○	
	Applied Arts	-	Fine Arts	○	○	X	Submit Artwork
Law (General graduate school)	Law	-	Humanities/ Social Sciences	○	○	○	
Policy Science	Public Administration	-	Humanities/ Social Sciences	○	○	○	
	Policy	-	Humanities/ Social Sciences	○	○	○	
	Science and Technology Policy	-	Humanities/ Social Sciences (interdisciplinary courses)	○	○	○	
Human Ecology	Food and Nutrition	Food and Nutrition	Physical Science	○	○	○	
	Food and Nutrition	Clinical Nutrition	Physical Science	○	○	○	
	Clothing and Textiles	-	Physical Science	○	○	○	
	Interior Design	-	Physical Science	○	○	○	Submit Artwork
Nursing	Nursing	Nursing	Physical Science	○	○	X	
Natural Science	Physics	-	Physical Science	○	○	○	
	Chemistry	-	Physical Science	○	○	○	
	Life Science	-	Physical Science	○	○	○	
	Mathematics	-	Physical Science	○	○	○	
	Environmental Science	-	Physical Science	○	○	○	
	Convergence Nano science	-	Physical Science (interdisciplinary courses)	○	○	○	
	Applied Statistics	-	Physical Science (interdisciplinary courses)	○	○	○	
Performing Arts and Sport	Theatre and Film	Theatre and Film(Theory)	Humanities/ Social Sciences	○	○	○	Submit Artwork
	Theatre and Film	Theatre and Film(Practical Skill)	Humanities/ Social Sciences	○	○	○	Submit Artwork
	Physical Education	-	Sports	○	○	X	
	Global Sports Industry and Management	-	Sports	○	○	○	
	Dance	Dance(Theory)	Fine Arts	○	○	X	Submit Artwork

College/Division	Department	Major	Field	Program			Note
				MA/ MS	Ph.D	MA/MS - Ph.D	
Music	Korean Traditional music	Composition	Music	○	○	X	Submit Artwork
	Korean Traditional music	Conducting	Music	○	○	X	Submit Artwork
	Korean Traditional music	Korean Musicology	Music	X	○	X	Submit Artwork (Check details)
	Korean Traditional music	Gayageum	Music	○	○	X	Submit Artwork
	Korean Traditional music	Geomungo	Music	○	○	X	Submit Artwork
	Korean Traditional music	Large transverse bamboo flute	Music	○	○	X	Submit Artwork
	Korean Traditional music	Pipe	Music	○	○	X	Submit Artwork
	Korean Traditional music	Korean fiddle	Music	○	○	X	Submit Artwork
	Korean Traditional music	Seven-stringed instrument	Music	○	○	X	Submit Artwork
	Korean Traditional music	Percussion Instrument	Music	○	○	X	Submit Artwork
	Korean Traditional music	Vocal music-Jungga	Music	○	○	X	Submit Artwork
	Korean Traditional music	Vocal music-Pansori	Music	○	○	X	Submit Artwork
	Korean Traditional music	Theory	Music	○	X	X	Submit Artwork (Check details)
	Korean Traditional music	Vocal music- Kyungseodosori	Music	○	○	X	Submit Artwork
	Music	Accompaniment	Music	○	○	X	Submit Artwork (Check details)
	Music	Composition	Music	○	○	X	Submit Artwork (Check details)
	Music	Voice	Music	○	○	X	Submit Artwork
	Music	Piano	Music	○	○	X	Submit Artwork (Check details)
	Music	Western Music History	Music	○	○	X	Submit Artwork (Check details)
	Music	Western Music Theory	Music	○	○	X	Submit Artwork (Check details)
	Music	Organ	Music	○	○	X	Submit Artwork (Check details)
	Music	Violin	Music	○	○	X	Submit Artwork
	Music	Viola	Music	○	○	X	Submit Artwork
	Music	Cello	Music	○	○	X	Submit Artwork
	Music	Contrabass	Music	○	○	X	Submit Artwork
	Music	Harp	Music	○	○	X	Submit Artwork
	Music	Cembalo	Music	○	○	X	Submit Artwork

[Seoul Campus]

College/Division	Department	Major	Field	Program			Note
				MA/ MS	Ph.D	MA/MS - Ph.D	
Music	Music	Bassoon	Music	○	○	X	Submit Artwork
	Music	Horn	Music	○	○	X	Submit Artwork
	Music	Tuba	Music	○	○	X	Submit Artwork
	Music	Oboe	Music	○	○	X	Submit Artwork
	Music	Clarinet	Music	○	○	X	Submit Artwork
	Music	Trumpet	Music	○	○	X	Submit Artwork
	Music	Trombone	Music	○	○	X	Submit Artwork
	Music	Flute	Music	○	○	X	Submit Artwork
	Music	Saxophone	Music	○	○	X	Submit Artwork
	Music	Percussion Instrument	Music	○	○	X	Submit Artwork
	Music	Conducting	Music	○	○	X	Submit Artwork
	Music	Computer Music Composition	Music	○	○	X	Submit Artwork (Check details)
	Music	New media performing & Technology	Music	○	○	X	Submit Artwork (Check details)
Medicine	Medicine	Physiology	Medicine	○	○	○	
	Medicine	Biochemistry	Medicine	○	○	○	
	Medicine	Pathology	Medicine	○	○	○	
	Medicine	Microbiology	Medicine	○	○	○	
	Medicine	Parasitology	Medicine	○	○	○	
	Medicine	Pharmacology	Medicine	○	○	○	
	Medicine	Preventive medicine	Medicine	○	○	○	
	Medicine	Family medicine	Medicine	○	○	○	
	Medicine	Anatomy/Cell Biology	Medicine	○	○	○	
	Medicine	Medical genetics	Medicine	○	○	○	
	Medicine	Biomedical engineering	Medicine	○	○	○	
	Medicine	Internal medicine	Medicine	○	○	○	
	Medicine	Orthopedic surgery	Medicine	○	○	○	
	Medicine	Neurosurgery	Medicine	○	○	○	
	Medicine	Thoracic and cardiovascular surgery	Medicine	○	○	○	
	Medicine	Plastic and reconstructive surgery	Medicine	○	○	○	
	Medicine	Pediatrics	Medicine	○	○	○	
	Medicine	Obstetrics and gynecology	Medicine	○	○	○	

College/Division	Department	Major	Field	Program			Note
				MA/ MS	Ph.D	MA/MS - Ph.D	
Medicine	Medicine	Dermatology	Medicine	○	○	○	
	Medicine	Urology	Medicine	○	○	○	
	Medicine	Otolaryngology	Medicine	○	○	○	
	Medicine	Ophthalmology	Medicine	○	○	○	
	Medicine	Dentistry	Medicine	○	○	○	
	Medicine	Rehabilitation medicine	Medicine	○	○	○	
	Medicine	Therapeutic radiology	Medicine	○	○	○	
	Medicine	Neurology	Medicine	○	○	○	
	Medicine	External medicine	Medicine	○	○	○	
	Medicine	Anesthesia and pain medicine	Medicine	○	○	○	
	Medicine	Diagnostic	Medicine	○	○	○	
	Medicine	Radiology	Medicine	○	○	○	
	Medicine	Occupational and environmental medicine	Medicine	○	○	○	
	Medicine	Psychiatry	Medicine	○	○	○	
	Medicine	Emergency medicine	Medicine	○	○	○	
	Medicine	Humanities and medical ethics	Medicine	○	○	○	
	Medicine	Medical education	Medicine	○	○	○	
	Medicine	Nuclear medicine	Medicine	○	○	○	
	Health Management	-	Medicine (interdisciplinary courses)	X	○	X	
	Personalized Genome Medicine	-	Medicine (interdisciplinary courses)	○	○	○	
	Global Health and Development (English Track)	-	Medicine (interdisciplinary courses)	○	○	○	English Track
	Child Psychotherapy	-	Medicine (interdisciplinary courses)	○	○	X	
International Studies	Russian Studies	-	Professional Graduate School	○	○	X	
	American Studies (English Track)	-	Professional Graduate School	○	○	X	English Track
	Chinese Studies	-	Professional Graduate School	○	○	X	
	Korean Studies	Korean Studies (English Track)	Professional Graduate School	○	○	X	English Track
	Korean Studies	Korean Language Education-Korean Studies	Professional Graduate School	○	X	X	
	Global Social Economy Studies	-	Professional Graduate School	○	X	X	
Technology & Innovation Management	Technology Management	-	Professional Graduate School	○	○	○	

02

Admission Unit

● 2018 Graduate School Departments

[Seoul Campus]

College/Division	Department	Major	Field	Program			Note
				MA/ MS	Ph.D	MA/MS - Ph.D	
Urban Studies	Department of Urban Development Management and Real Estate	Urban Development and Management	Professional Graduate School (Humanities/ Social Sciences)	○	○	○	Submit Artwork (Option)
	Department of Urban Development Management and Real Estate	Real Estate	Professional Graduate School (Humanities/ Social Sciences)	○	○	○	Submit Artwork (Option)
	Department of Urban Design and Landscape Ecological Architecture	Urban Regeneration and Design	Professional Graduate School	○	○	○	Submit Artwork (Option)
	Department of Urban Design and Landscape Ecological Architecture	Landscape Urbanism	Professional Graduate School	○	○	○	Submit Artwork (Option)
Biomedical Science and Engineering Biomedical Science	Biomedical Engineering	-	Professional Graduate School	○	○	○	
	Biomedical Science	-	Professional Graduate School	○	○	○	
	Translation Medical Science	-	Professional Graduate School	○	○	○	
	Biomedical Informatics	-	Professional Graduate School	○	○	○	
MBA	(DAY) Global YES MBA (Young Entrepreneur Spirit)	-	Professional Graduate School	○	X	X	
	(DAY) Korea and Asia Business Studies MBA (English Track)	-	Professional Graduate School	○	X	X	English Track
	(DAY) Global Business Management MBA	-	Professional Graduate School	○	X	X	
	(NIGHT) Hanyang MBA	-	Professional Graduate School	○	X	X	
	(NIGHT) Digital Business MBA	-	Professional Graduate School	○	X	X	
	(NIGHT) Finance MBA	-	Professional Graduate School	○	X	X	
	(NIGHT) Arts, Culture & Entertainment MBA	-	Professional Graduate School	○	X	X	
	(NIGHT) Healthcare Management MBA	-	Professional Graduate School	○	X	X	
	(NIGHT) Strategic Project Management MBA	-	Professional Graduate School	○	X	X	
	(NIGHT) Newspaper, Magazine & Publishing	-	Specialized Graduate School	○	X	X	5 semesters
Journalism and Mass Communication	(NIGHT) Advertising and Public Relations	-	Specialized Graduate School	○	X	X	5 semesters
	(NIGHT) Broadcasting & Visual Communication	-	Specialized Graduate School	○	X	X	5 semesters
	(NIGHT) Digital Media	-	Specialized Graduate School	○	X	X	5 semesters

College/Division	Department	Major	Field	Program			Note
				MA/ MS	Ph.D	MA/MS - Ph.D	
Public Policy	(NIGHT) Public Administration	General Administration	Specialized Graduate School	○	X	X	5 semesters
	(NIGHT) Public Administration	Crisis and Emergency Management	Specialized Graduate School	○	X	X	5 semesters
	(NIGHT) Public Administration	Policy Science	Specialized Graduate School	○	X	X	5 semesters
	(NIGHT) Local Autonomy	Local Self-Government	Specialized Graduate School	○	X	X	5 semesters
	(NIGHT) Local Autonomy	Local and Urban Administration	Specialized Graduate School	○	X	X	5 semesters
	(NIGHT) Local Autonomy	Negotiation	Specialized Graduate School	○	X	X	5 semesters
	(NIGHT) Healthcare Administration	Hospital Administration	Specialized Graduate School	○	X	X	5 semesters
	(NIGHT) Healthcare Administration	Nursing Administration	Specialized Graduate School	○	X	X	5 semesters
	(NIGHT) Healthcare Administration	International Health Care Management	Specialized Graduate School	○	X	X	5 semesters
	(NIGHT) Healthcare Administration	Integrative Healthcare Management	Specialized Graduate School	○	X	X	5 semesters
	(NIGHT) Social Welfare	Social Welfare Policy	Specialized Graduate School	○	X	X	5 semesters
	(NIGHT) Social Welfare	Social Welfare Practice	Specialized Graduate School	○	X	X	5 semesters
	(NIGHT) Social Welfare	Aging and Low Fertility	Specialized Graduate School	○	X	X	5 semesters
	(NIGHT) Civil Society	Civil Society	Specialized Graduate School	○	X	X	5 semesters
	(NIGHT) Civil Society	Volunteering	Specialized Graduate School	○	X	X	5 semesters
	(NIGHT) Civil Society	Global Development	Specialized Graduate School	○	X	X	5 semesters
	(NIGHT) Civil Society	Social Impact	Specialized Graduate School	○	X	X	5 semesters
	(NIGHT) Legal Affairs	Legal Affairs of Court Administration	Specialized Graduate School	○	X	X	5 semesters
	(NIGHT) Legal Affairs	Legal Affairs of Public Administration	Specialized Graduate School	○	X	X	5 semesters
	(NIGHT) Legal Affairs	Legal Affairs of Business Management	Specialized Graduate School	○	X	X	5 semesters
International Tourism	(NIGHT) International Tourism	Tourism & Hospitality Administration	Specialized Graduate School	○	X	X	5 semesters
	(NIGHT) International Tourism	Tourism & Hospitality Administration	Specialized Graduate School	○	X	X	5 semesters
	(NIGHT) Culture · entertainmnet Tourism	Culture · entertainmnet Tourism	Specialized Graduate School	○	X	X	5 semesters

[ERICA Campus]

College/Division	Department	Major	Field	Program			Note
				MA/MS	Ph.D	MA/MS – Ph.D	
Engineering Sciences	Transportation Engineering	–	Engineering	○	○	○	
	Architectural Design	–	Engineering	○	○	○	
	Industrial & Management Engineering	–	Engineering	○	○	○	
	Architectural System Engineering	–	Engineering	○	○	○	
	Computer Science and Engineering	–	Engineering	○	○	○	
	Mechatronics Engineering	–	Engineering	○	○	○	
	Bionanotechnology	Bioengineering	Engineering	○	○	○	
	Bionanotechnology	Nanotechnology	Engineering	○	○	○	
	Bionanotechnology	Bionanotechnology	Engineering	○	○	○	
	Mechanical Design Engineering (mech.hanyang.ac.kr)	–	Engineering	○	○	○	
	Interdisciplinary Engineering System	–	Engineering (interdisciplinary courses)	○	○	X	
	Frontier Materials Engineering	–	Engineering (interdisciplinary courses)	○	○	○	
	Civil & Environmental System Engineering	–	Engineering	○	○	○	
	Electronics Engineering	–	Engineering	○	○	○	
	Materials Chemical Engineering	–	Engineering	○	○	○	
	Robot Engineering	–	Engineering	○	○	○	
Computing	Human–Computer Interaction	–	Engineering	○	○	○	
Business and Economics	Strategic Management	Marketing	Humanities/Social Sciences	○	○	○	
	Strategic Management	Human Resource Management	Humanities/Social Sciences	○	○	○	
	Strategic Management	Strategy	Humanities/Social Sciences	○	○	○	
	Strategic Management	Service and Operation Management	Humanities/Social Sciences	○	○	○	
	Management Consulting	Management Consulting	Humanities/Social Sciences	○	○	○	
	Management Consulting	GBC(Global Business Consulting)	Humanities/Social Sciences	○	○	○	
	Applied Economics	–	Humanities/Social Sciences	○	○	X	
	Insurance & Finance	Insurance & Finance	Humanities/Social Sciences	○	○	○	
	Insurance & Finance	Banking & Finance	Humanities/Social Sciences	○	○	X	
	Insurance & Finance	Accounting	Humanities/Social Sciences	○	○	○	
	Applied Physics	–	Physical Science	○	○	○	
Science Convergence Technology	Applied Mathematics	–	Physical Science	○	○	○	
	Molecular Life Science	–	Physical Science	○	○	○	
	Applied Chemistry	–	Physical Science	○	○	○	
	Convergence Marine Sciences	–	Physical Science	○	○	○	

College/Division	Department	Major	Field	Program			Note
				MA/MS	Ph.D	MA/MS – Ph.D	
Languages and Cultures	Cultural Anthropology	–	Humanities/ Social Sciences	○	○	○	
	Japanese Language and Culture	–	Humanities/ Social Sciences	○	○	○	
	English Course and Materials development	–	Humanities/ Social Sciences	○	X	X	
	Digital Culture Contents	–	Humanities/Social Sciences (interdisciplinary courses)	○	○	X	
Design	Design	Surface Interior Design	Fine Arts	○	○	○	Submit Artwork
	Design	Jewelry Fashion Design	Fine Arts	○	○	○	Submit Artwork
	Design	Industrial Design	Fine Arts	○	○	○	Submit Artwork
	Design	Graphic Design	Fine Arts	○	○	○	Submit Artwork
	Design	Multimedia Design	Fine Arts	○	○	○	Submit Artwork
	Pharmacy	Pharmacy	Pharmacy	○	○	○	
Communication & Social Science	Advertising & Public relations	–	Humanities/ Social Sciences	○	○	○	
	Journalism & Mass Communication	–	Humanities/ Social Sciences	○	○	X	
	Life Sports and Well-Being	–	Sports	○	○	X	
	Performance Art	–	Fine Arts	○	○	X	
	Applied Music	–	Music	○	X	X	
Computing	Human–Computer Interaction	–	Engineering	○	○	○	
Industrial Convergence	(NIGHT) Business Administration	–	Specialized Graduate School (Humanities/Social Sciences)	○	X	X	5 semesters
	(NIGHT) Design	–	Specialized Graduate School (Fine Arts)	○	X	X	5 semesters
	(NIGHT) Culture Contents	–	Specialized Graduate School (Humanities/Social Sciences)	○	X	X	5 semesters
	(NIGHT) Performing Arts Management	–	Specialized Graduate School (Humanities/Social Sciences)	○	X	X	5 semesters

- * International student can apply for the courses listed above.
- * Courses are subject to change and will be confirmed before semester starts. Please check the courses you wish to study prior to online application.

03

Application Schedule

Procedure	Schedule				Note
	2018 Fall Semester Admission (September)		2019 Spring Semester Admission (March)		
Guideline announcement	Mar. 1, 2018		Sept. 3, 2018		Download from Office of International Affairs Website (http://study.hanyang.ac.kr)
Online application	Undergrad	April 9~20, 2018	Undergrad	Sept. 10~21, 2018	Check a notice and apply online (http://study.hanyang.ac.kr)
	Grad	April 9~27, 2018	Grad	Sept. 10~28, 2018	
Submit required documents	Undergrad	April 9~24, 2018	Undergrad	Sept. 10~21, 2018	– Refer to required documents – Submit by mail or visit [Address] Office of international Affairs, Room218, International Building, Hanyang University 222 Wangsimni-ro, Seongdong-gu, Seoul (04763), Republic of Korea
	Grad	April 9~27, 2018	Grad	Sept. 10~28, 2018	
[Undergraduate Applicants] Admission test and Korean language proficiency test	May. 19, 2018 (tentative)		Oct. 20, 2018 (tentative)		– Session1: Admission test – Session2: Korean Language Proficiency Test ※ Foreign applicants residing in China can take admission and Korean tests at designated test venues in China (Inquiries: www.hanyangdaxue.com) ※ Foreign applicants residing overseas (excluding China, Taiwan, Hong Kong and Japan) will take the Korean proficiency test in Korea after result announcement
[Graduate Applicants] Korean language proficiency test	May. 19, 2018		Oct. 20, 2018		No Admission Test for Graduate School Applicants
Result announcement	June. 15, 2018		Dec. 5, 2018		Check from office of international affairs website. (http://study.hanyang.ac.kr > Admissions > Regular admission result)
Deposit payment	-		Dec. 17~28, 2018 (tentative)		– Refer to guidelines for successful applicants after result announcement – Pay with virtual account
Tuition payment	July. 2~13, 2018 (tentative)		Feb., 2019 (tentative)		
Korean language proficiency re-test	Aug., 2018 (tentative)		Feb., 2019 (tentative)		– For students (undergraduate and graduate) who pass admission but do not satisfy Korean standards – Time and venue will be announced
Undergraduate students orientation Graduate students orientation	Aug. 3, 2018 (tentative) Aug. 10, 2018 (tentative)		Feb. 22, 2019 (tentative) Feb. 15, 2019 (tentative)		Time and venue will be announced
Entrance Ceremony	Aug. 31, 2018 (tentative)		Feb. 28, 2019 (tentative)		
Beginning of each semester	Sept. 3, 2018		Mar. 4, 2019		

- * Applicants must submit all required documents no later than 17:00 of document submission deadline. Those who fail to do so can be faced with disadvantages. Those who are expected to graduate should submit graduation certificates (Undergrad) and degree certificates (Grad) before the beginning of each semester.
- * This schedule above can subject to change, and all the notification for the admission will be announced on office of international affairs website. (<http://study.hanyang.ac.kr> > Admissions > Notice)
(There will be no announcement on a personal basis.)

04

Eligibility Requirements for Application

Type		Eligibility Requirements
Undergraduate School	Freshman	1. Nationality : International students with foreign nationality whose parents both have foreign nationality – Students and their parents should acquire foreign nationality before the students enter high school – If the students and their parents have dual nationality, they both should lose their Korean nationality before the students enter high school 2. Academic background : Those who graduated or are expected to graduate from high school
	Transfer	1. Nationality : International students with foreign nationality whose parents both have foreign nationality – Students and their parents should acquire foreign nationality more than 3 years from the application date – If the students and their parents have dual nationality, they both should lose their Korean nationality 3 years before the application date 2. Academic background : International students who completed at least 2 years (4 regular semesters, excluding summer, winter sessions) of home and foreign undergraduate education (must have earned all the credits required to complete 4 or more semesters) and wish to transfer to the third year(junior) in undergraduate program at Hanyang University. – Students who went to community college must graduate (with associate degree or diploma equivalent to associate degree) from the school or must be on the list of candidates for graduation. – Students who went to college(s) which is/are not officially approved by the Ministry of Education are not eligible to apply for transfer admission. 3. Major : International students who will apply for relevant majors in Hanyang University from their previous university's major
Graduate School	International students with foreign citizenship whose parents both have foreign citizenship	1. International students with foreign citizenship whose parents both have foreign citizenship – As of the application date, students and their parents should acquire foreign citizenship – If the students and their parents have dual citizenship, they both should lose their Korean citizenship before the application date 2. Academic background: Bachelor's degree required for Master's program admission (Those who can get Bachelor's degree before the beginning of each semester) / Master's degree required for Doctoral Program admission (Those who can get Master's degree before the beginning of each semester)
	International students including Koreans residing overseas who have completed the entire elementary, middle, high school and undergraduate education outside Korea	1. International students including Koreans residing overseas who have completed the entire elementary, middle, high school and undergraduate education outside Korea 2. Academic background: Bachelor's degree required for Master's program admission (Those who can get Bachelor's degree before the beginning of each semester) / Master's degree required for Doctoral Program admission (Those who can get Master's degree before the beginning of each semester)

<Notice related to eligibility>

- * Those with dual nationality holding Korean nationality is not recognized as an international student.
- * Home-schooling, Cyber learning, Adult education are not recognized as academic backgrounds.
- * If only one of students' parents is legally admitted as a family, only the nationality of father or mother who is legally relevant will be reflected on the qualification of application. (Relevant documents should be submitted.)



05 Required Documents

1) Undergraduate – Freshmen Admission

No.	Required Documents	Note
1	Single copy of the application form	Must be printed out after the online application through the website of Office of International Affairs and pay application fee (138,000 KRW) ※ Applicants who choose ERICA campus as 2nd choice need to pay only transaction fee (8,000 won) more.
2	Single copy of official authorization for inquiry into enrollment and academic credit	Automatically printed when printing out the online application form <u>Only fill in the upper side of paper which is for students</u>
3	Single copy of personal statement and study plan	Must be written online and will be automatically printed when printing out the online application form ※ English or Korean (Must include a translated copy if written in other languages than English or Korean) ※ Students who want dual application, should fill in their form for each campus
4	CHSI* certificate (English ver.) (* China Higher Education Student Information)	– Chinese school graduates only – Certificate should include score of each subjects – If you did not take General Examination for High School Graduates, you must submit CHSI certificate of National Higher Education Entrance Examination.
5	Official high school graduation certificate	<Applicants who are not Chinese> – Apostille certification or Consul's Confirmation (Korean or English) <Chinese Applicants> – High school graduation certificate and transcript with translated notarization (Korean or English) – For those who graduated from vocational high schools should submit vocational high school graduate certificates and transcripts with authentication certificates for both documents from CHSI (China Higher Education Student Information and Career Center). (Transcript can be submitted with CHSI certificate(English) or Consul's confirmation(Korean or English))
6	Official high school 3-year transcript	
7	Copies of passports (applicants and parents)	Chinese applicants should submit additional documents – Copies of identification card and certificate of registered residence (applicant and parents)
8	Official document indicating parent-child relationship between applicant and his/her parents	<Applicants who are not Chinese> – Original copy of birth certificate (Must be translated into Korean or English and notarized if the original is in a language other than English) <Chinese Applicant> – Certificate of family relationship with translated notarization (Korean or English) – Copy of applicants and his/her parents family book must be submitted
9	A certificate authenticating bank balance (USD 20,000 or higher)	– Certificate of bank balance must be submitted (Copy of bankbook is not allowed) – Other currency which is equivalent to USD 20,000 is possible (e.g. RMB 140,000, KRW 23,000,000 etc.) – Certificate of balance with expiration date must be valid until the date after class starts. (Those applying for fall semester should have certificates valid until September 2018, and March 2019 for spring semester)
10	Certificate of TOPIK score – TOPIK level 4 and higher (Seoul) – TOPIK level 3 and higher (ERICA)	– Only for holders – Applicants for International Studies do not need to submit – Expiration date : Should expire after the starting date of online application
11	Certificate of English language proficiency test score (TOEFL, IELTS)	– Only for holders – Applicants for International Studies must submit (TOEFL IBT 89 and higher, or IELTS 6.5 and higher) – Expiration date : Should expire after the starting date of online application
12	Artworks or Achievements (Departments not requiring admission test)	Detail information is on <6.Admission Procedure>
13	Proof of denationalization (Only for those who were Korean and changed nationality)	Proof of denationalization of Korean citizenship with authorized date and other information indicated (both applicant and his/her parents) – explanation for denationalization and date must be written

05

Required Documents

2) Undergraduate – Transfer

No.	Required Documents	Note
1	Single copy of the application form	Must be printed out after the online application through the website of Office of International Affairs and pay application fee (138,000 KRW) ※ Applicants who choose ERICA campus as 2nd choice need to pay only transaction fee (8,000 won) more.
2	Single copy of official authorization for inquiry into enrollment and academic credit	Automatically printed when printing out the online application form Only fill in the upper side of paper which is for students
3	Single copy of personal statement and study plan	Must be written online and will be automatically printed when printing out the online application form ※ English or Korean (Must include a translated copy if written in other languages than English or Korean) ※ Students who want dual application, should fill in their form for each campus
4	High school graduation certificate with Apostille certificate or Consul's confirmation (English ver.)	Only for students still attending the 4-year university (For the proof of the highest level of education)
5	Certificate of graduation(or enrollment/ expected graduation) of former university	<Applicants who are not Chinese> – Apostille certification or Consul's Confirmation (Korean or English) <Chinese Applicants> – 4-year university: CDGDC certificate (English ver.) – 2 or 3-year junior college: CHSI certificate (English ver.) ※ Must be submitted the transcript with the score of all grades and credits for credit transfer. If not, credits will not be transferred.
6	Transcript of former university	
7	Proof of previous university's (relevant major) required credit for graduation	For those who apply for transfer admission, need to submit a proof of previous university's (relevant major) required credit for graduation. (It can be submitted in the form of information from the university website or a letter from the university)
8	Copies of passports (applicants and parents)	Chinese applicants should submit additional documents – Copies of identification card and certificate of registered residence (applicant and parents)
9	Official document indicating parent-child relationship between applicant and his/her parents	<Applicants who are not Chinese> – Original copy of birth certificate (Must be translated into Korean or English and notarized if the original is in a language other than English) <Chinese Applicant> – Certificate of family relationship with translated notarization (Korean or English) – Copy of applicants and his/her parents family book must be submitted
10	A certificate authenticating bank balance (USD 20,000 or higher)	– Certificate of bank balance must be submitted (Copy of bankbook is not allowed) – Other currency which is equivalent to USD 20,000 is possible (e.g. RMB 140,000, KRW 23,000,000 etc.) – Certificate of balance with expiration date must be valid until the date after class starts. (Those applying for fall semester should have certificates valid until September 2018, and March 2019 for spring semester)
11	Certificate of TOPIK score – TOPIK level 4 and higher (Seoul) – TOPIK level 3 and higher (ERICA)	– Only for holders – Applicants for International Studies do not need to submit – Expiration date : Should expire after the starting date of online application
12	Certificate of English language proficiency test score (TOEFL, IELTS)	– Only for holders – Applicants for International Studies must submit (TOEFL IBT 89 and higher, or IELTS 6.5 and higher) – Expiration date : Should expire after the starting date of online application
13	Artworks or Achievements (Departments not requiring admission test)	Detail information is on <6.Admission Procedure>
14	Proof of denationalization (Only for those who were Korean and changed nationality)	Proof of denationalization of Korean citizenship with authorized date and other information indicated (both applicant and his/her parents) – explanation for denationalization and date must be written

3) Graduate – M.A

No.	Required Documents	Note
1	Single copy of the application form	Must be printed out after the online application through the website of Office of International Affairs and pay application fee (138,000 KRW)
2	Single copy of official authorization for inquiry into enrollment and academic credit	Automatically printed when printing out the online application form Only fill in the upper side of paper which is for students
3	Single copy of personal statement and study plan	Must be written online and will be automatically printed when printing out the online application form ※ English or Korean (Must include a translated copy if written in other languages than English or Korean)
4	Bachelor's degree or Certificate of the expected graduation	Students who transferred to Korean university from foreign university (after studying at least for 2 years in foreign university) must submit a certificate that you studied in that foreign university <Applicants who are not Chinese> – Apostille certification or Consul's Confirmation (Korean or English) <Chinese Applicants> – CDGDC Certificate of bachelor's degree and copy of bachelor's degree (English)
5	Official transcript of Bachelor's degree	Students who transferred to Korean university from foreign university (after studying at least for 2 years in foreign university) must submit a transcript of foreign university <Applicants who are not Chinese> – Apostille certification or Consul's Confirmation (Korean or English) <Chinese Applicants> – CDGDC Certificate of transcript and copy of transcript (English)
6	Certificate of GPA converted into 100 scale or percentage (If you don't submit this certificate, you cannot apply for HISP scholarship)	– Submit 1 of the following 2 documents 1) An official document issued by the applicant's alma mater describing a grade point average (GPA) converted into 100 scale or percentage (English or Korean) 2) US WES ICAP (Course-by-Course Evaluation) certificate – WES basic or iGPA calculator is not acceptable
7	Copies of passports (applicants and parents)	Chinese applicants should submit additional documents – Copies of identification card and certificate of registered residence (applicant and parents)
8	Official document indicating parent-child relationship between applicants and his/her parents	<Applicants who are not Chinese> – Original copy of birth certificate (Must be translated into Korean or English and notarized if the original is in a language other than English) <Chinese Applicant> – Certificate of family relationship with translated notarization (Korean or English) – Copy of applicants and his/her parents family book must be submitted
9	A certificate authenticating bank balance (USD 20,000 or higher)	– Certificate of bank balance must be submitted (Copy of bankbook is not allowed) – Other currency which is equivalent to USD 20,000 is possible (e.g. RMB140,000, KRW 23,000,000 etc.) – Certificate of balance with expiration date must be valid until the date after class starts. (Those applying for fall semester should have certificates valid until September 2018, and March 2019 for spring semester)
10	Certificate of TOPIK score – TOPIK level 4 and higher	– Only for holders – Applicants for English track do not need to submit – Expiration date: Should expire after the starting date of online application
11	Certificate of English language proficiency test score (TOEFL, IELTS)	– Only for holders – Expiration date : Should expire after the starting date of online application
12	Artworks or Achievements (Applicants for relevant departments only)	Detailed information is on <6.Admission Procedure>
13	Proof of nationality renunciation (Only for those who renounces Korean citizenship)	Proof of renunciation of Korean citizenship with authorized date and other information indicated (both applicants and his/her parents) – explanation for nationality renunciation and date must be written
14	Certificate of entry & exit (Only for the Koreans residing overseas who have completed the entire elementary, middle, high school and undergraduate education outside Korea)	From date of birth to starting date of online application.
15	Graduation certificates and transcripts of elementary, middle and high school (English ver.) (Only for the Koreans residing overseas who have completed the entire elementary, middle, high school and undergraduate education outside Korea)	Submit 1 of 3 below 1) Apostille certification 2) Consul's confirmation 3) Confirmation from Overseas Koreans Education Information Service ※ Students who went to Korean schools acknowledged by the Ministry of Education of Korea are exempted from submitting above

05

Required Documents

4) Graduate – Ph.D.

No.	Required Documents	Note
1	Single copy of the application form	Must be printed out after the online application through the website of Office of International Affairs and pay application fee (138,000 KRW)
2	Single copy of official authorization for inquiry into enrollment and academic credit	Automatically printed when printing out the online application form Only fill in the upper side of paper which is for students
3	Single copy of personal statement and study plan	Must be written online and will be automatically printed when printing out the online application form ※ English or Korean (Must include a translated copy if written in other languages than English or Korean)
4	Master's degree or Certificate of the expected graduation (English ver.)	<Applicants who are not Chinese> – Apostille certification or Consul's Confirmation (Korean or English) <Chinese Applicants> – CDGDC Certificate of Master's degree and copy of Master's degree (English)
5	Official transcript of Master's degree	<Applicants who are not Chinese> – Apostille certification or Consul's Confirmation (Korean or English) <Chinese Applicants> – CDGDC Certificate of transcript and copy of transcript (English)
6	Certificate of GPA converted into 100 scale or percentage (If you don't submit this certificate, you cannot apply for HISP scholarship)	– Submit 1 of the following 2 documents 1) An official document issued by the applicant's alma mater describing a grade point average (GPA) converted into 100 scale or percentage (English or Korean) 2) US WES ICAP (Course-by-Course Evaluation) certificate – WES basic or iGPA calculator is not acceptable
7	Copies of passports (applicants and parents)	Chinese applicants should submit additional documents – Copies of identification card and certificate of registered residence (applicant and parents)
8	Official document indicating parent-child relationship between applicant and his/her parents	<Applicants who are not Chinese> – Original copy of birth certificate (Must be translated into Korean or English and notarized if the original is in a language other than English) <Chinese Applicant> – Certificate of family relationship with translated notarization (Korean or English) – Copy of applicants and his/her parents family book must be submitted
9	A certificate authenticating bank balance (USD 20,000 or higher)	– Certificate of bank balance must be submitted (Copy of bankbook is not allowed) – Other currency which is equivalent to USD 20,000 is possible (e.g. RMB140,000, KRW 23,000,000 etc.) – Certificate of balance with expiration date must be valid until the date after class starts. (Those applying for fall semester should have certificates valid until September 2018, and March 2019 for spring semester)
10	Certificate of TOPIK score – TOPIK level 4 and higher	– Only for holders – Applicants for English track do not need to submit – Expiration date: Should expire after the starting date of online application
11	Certificate of English language proficiency test score (TOEFL, IELTS)	– Only for holders – Expiration date : Expire after the starting date of online application
12	Artworks or Achievements (Applicants for relevant departments only)	Detail information is on <6,Admission Procedure>
13	Proof of nationality renunciation (Only for those who renounces Korean citizenship)	Proof of renunciation of Korean citizenship with authorized date and other information indicated (both applicants and his/her parents) – explanation for nationality renunciation and date must be written
14	Certificate of entry & exit (Only for the Koreans residing overseas who have completed the entire elementary, middle, high school and undergraduate education outside Korea)	From date of birth to starting date of online application.
15	Graduation certificates and transcripts of elementary, middle and high school (English ver.) (Only for the Koreans residing overseas who have completed the entire elementary, middle, high school and undergraduate education outside Korea)	Submit 1 of 3 below 1) Apostille certification 2) Consul's confirmation 3) Confirmation of Overseas Koreans Education Information Service ※ Students who went to Korean schools acknowledged by the Ministry of Education of Korea are exempted from submitting above

<Notice related to required documents>

- ❶ Documents not written in Korean or English must be submitted with Korean (or English) translated notarization.

❷ Other documents (prize or license) not written in Korean or English must be submitted with Korean (or English) translated notarization.

❸ If students, who are not graduated, are accepted to our university, should submit their final academic certificate before the beginning of each semester.

❹ For the students who want to submit their documents from abroad, please send them to the address written below
[Address] Office of International Affairs, Room 218, International Building, Hanyang University
222 Wangsimni-ro, Seongdong-gu, Seoul (04763), Republic of Korea

❺ If the certificate of academic degree is needed, please ask relevant agency and prepare the documents.

❻ All notarized and certificated documents for the submission must be issued within a year from the starting date of online application.

❼ Admission can be canceled if the academic background and the contents of documents are different.

❽ Applicants must submit all required documents no later than 17:00 of document submission deadline. Those who fail to do so can be faced with disadvantages. Those who are expected to graduate should submit graduation certificates (Undergrad) and degree certificates (Grad) before the beginning of each semester.

❾ All the submitted documents will not be returned.

Notice for documents submission

1. Submit the documents in order

2. Do not use stapler or clip

3. Do not submit photo and recommendation letter

4. Every documents should be A4 size



Information related to Document Verification

Apostille Certification and Consul’s Confirmation

[1] Introduction for submitting a document to prove the academic history from overseas institutions

All applicants except those who have graduated in China must submit an official diploma or degree and an official academic transcript verified by one of the following verification method stated below during the designated period.

- 1) Apostilled Official diploma or degree and official academic transcript
- 2) Official diploma or degree and official academic transcript verified by a Korean Embassy

[2] Information on Apostille Convention

- 1. Apostille Convention
 - 1) The Republic of Korea became the 90th Contracting State of the Apostille Convention (Convention Abolishing the Requirement of Legalization for Foreign Public Document), effective as of July 14, 2007
 - 2) Apostille is a certificate specifying the modalities through which a document issued in one of the signatory countries can be certified for legal purposes in all the other signatory states
 - 3) Apostille convention countries abolish the complex consular procedures to ensure the mutual authentication of public and official documents (Apostilled documents have the same effect as documents verified by diplomatic offices)
- 2. Apostille Convention is an international treaty drafted by the Hague Conference on Private International Law: You can check out detailed updated information regarding regional authorities at www.hcch.net

[3] The procedure of issuing Apostille



[4] Apostille Convention countries (Based on 2016.08.30. 113 Countries)

Area	Total	Members
Asia, Oceania	17	Australia, Macao, Hong Kong, Japan, Republic of Korea, New Zealand, Brunei, Mongolia, Cook Islands, Fiji, India, Marshall Islands, Mauritius, Vanuatu, Samoa, Tunga, Niue
Europe	53	Albania, Austria, Belarus, Belgiu, Bosnia and Herzegovina, Bulgaria, Croatia, Cyprus, Czech, Denmark, Estonia, Finland, France, Georgia, Germany, Malta, Greece, Hungary, Iceland, Ireland, Italy, Latvia, LiThuania, Luxembourg, Monaco, Montenegro, Netherlands, Norway, Poland, Portugal, Russia, Romania, Serbia, Slovakia, Slovenia, Spain, Sweden, Switzerland, Turkey, Kyrgyzstan, Macedonia, Ukraine, England, Andorra, Armenia, Azerbaijan, Moldova, Liechtenstein, San Marino, Kazakhstan, Uzbekistan, Kosovo
North America	1	United States of America
Latin America and the Caribbean	27	Argentina, Mexico, Panama, Republic of Suriname, Bolivarian Republic of Venezuela, Antigua and Barbuda, Bahamas, Barbados, Belize, Colombia, Dominica, Dominican Republic, Ecuador, El Salvador, Granada, Honduras, Saint Vincent, Peru, Trinidad and Tobago, Saint Lucia, Saint Kitts and Nevis, Costa Rica, Uruguay, Nicaragua, Paraguay, Brazil, Chile
Africa	11	South Africa, Botswana, Burundi, Lesotho, Liberia, Namibia, Sao Tome and Principe, Swaziland, Malawi, Cape Verde, Seychelles
Middle East	4	Oman, Israel, Bahrain, Morocco

WES ICAP (For Graduate School Applicants who want to submit GPA Certification)

[1] Information on WES

- Institution: WES (World Education Service)
- Web: <https://www.wes.org/>
- Address: Documentation Center P. O. Box 5087 Bowling Green Station, New York, NY 10274–5087, USA
- Contact: 1– 212–966–6311
- Cost: \$205.00 (Price does not include delivery or additional fees)

[2] The procedure of issuing WES ICAP

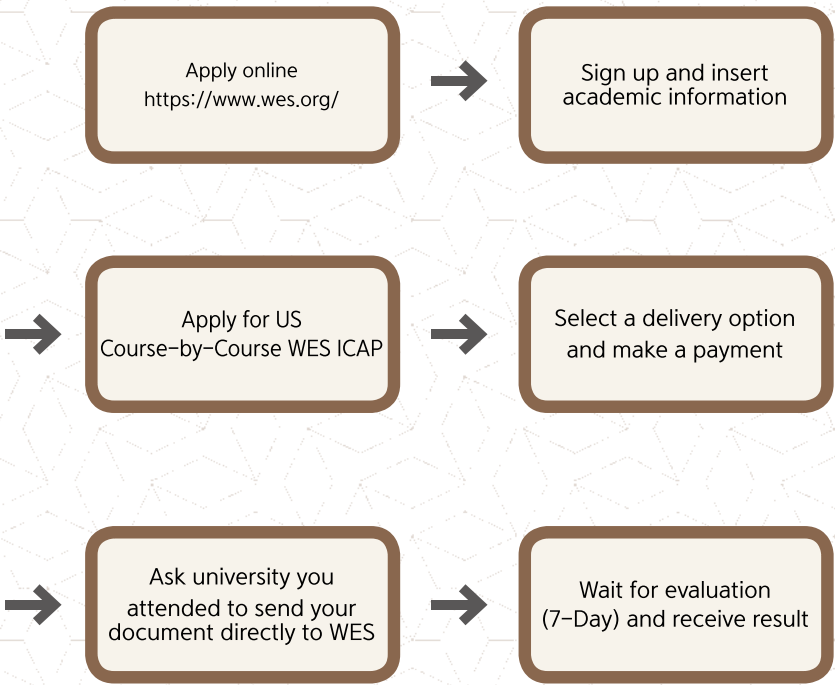

※ Please visit following website for detailed information.
(<https://www.wes.org/evaluations-and-fees/education/graduate-admissions/>)

06

Selection Procedure

1) Undergraduate schools

- Evaluation Type 1 : Document screening + Admission Test
(Admission test is for all departments except for departments which are stated in Evaluation Type 2)
- * The following departments require additional procedures besides document screening and admission test.

Campus	College	Department	Procedure
Seoul Campus	7 Diamond departments	Electronic communication Engineering Computer Software Engineering Energy Engineering Automotive Engineering Policy Public Administration Financial Management	Document screening + Admission Test + Direct evaluation of the department
	International Studies	International Studies	Document screening + Admission Test (should be written in English) + English Interview
	Theater and Film	Film major	Document screening + Admission Test

- Evaluation Type 2 : Document screening + Artwork screening
(Admission test will be exempted for departments which require artwork)

Campus	College	Department	Procedure
Seoul Campus	Human Ecology	Interior Design Clothing and Textiles	Document screening + Artwork screening
	Music	Voice Composition Piano String and Wind Instrument Korean Traditional Music	
	Fine arts and Physical Education	Dance Physical Education Sport Industry and Management	
		Theater and Film (Acting major, Play directing major)	Document screening + Artwork screening + Performance screening
ERICA Campus	Design	Jewelry Fashion Design Surface Interior Design Technology Product Design Communication Design Entertainment Design	Document screening + Artwork screening
	Sports and Arts	Sports Science Dance and Performing Arts Applied Music	

- * Theater and Film department (Acting major, Play directing major) in Seoul campus conducts additional performance screening.
- * Applicants for departments which do not require admission test must submit a sample of his/her works. However, applicants for Interior Design, Clothing and Textile, Physical Education and Sports Industry and Management can take the admission test instead of submitting a sample of his/her works.
 - Music, Dance and Physical Education: a video CD or USB which includes at least two personal music, dance or physical education compositions and work
 - Art and Design: At least two pieces of artwork or Portfolio

<Details on artworks of College of Music>

Department	Assignment	
	Song in Italian	Song in German
Voice(Male)	1. Già il sole dal Gange (A.Scarlatti) 2. Vergin, tutto amor (F.Durante) 3. O del mio dolce ardor (C.Gluck) 4. O del mio amato ben (S.Donaudy) 5. Vaghiissimasembianza (S.Donaudy)	1. An die Musik (F.Schbert) 2. Die forelle (F.Schubert) 3. Die Post (F.Schubert) 4. Du bist die Ruh (F.Schubert) 5. Die Lotosblume (R.Schumann) 6. Widmung (R.Schumann)
Voice(Female)	1. Bel piacere (G,F.Handel) 2. V'adoro Pupille (G,F.Handel) 3. Lungi dal caro bene (A.Secchi) 4. La Fioraia Fiorentina (G.Rossini) 5. Sognai (F.Schira)	1. Das Veilchen (W.A.Mozart) 2. Die forelle (F.Schubert) 3. Du bist die Ruh (F.Schubert) 4. Die Lotosblume (R.Schumann) 5. Widmung (R.Schumann) 6. Immer leiser (J.Brahms)
	* One of Italian aria or one of 'Song in Italian' above * One of 'Song in German' above	
Composition	1. 1 sheet music composed with music expression of Korean traditional music or Western classical music 2. Performance video with one fast movement from any of Beethoven Sonatas	
Piano	1. One fast movement from any of Beethoven sonatas 2. One etude by F. Chopin or F. Liszt 3. One work of applicant's choice with the minimum length of 5 minutes	
String and Wind Instrument (Violin)	· 1 song of the applicant's selection · One of the violin scales	
String and Wind Instrument (Percussion)	· 1 marimba song of the applicant's selection · Snare drum, M. Markovich : The Winner (1 minute)	
String and Wind Instrument (Others)	· 1 song of the applicant's selection	
Korean Traditional Music (Instrumental music)	1 song of the applicant's selection played by Korean or applicant's native musical instrument (video submission is available) * Applicants can enter the major of similar traditional musical instrument after the examination	
Korean Traditional Music (Voice)	2 of any voice songs among Korean or applicant's native music (video submission is available) * Applicants can enter Korean Traditional Voice major after the examination	
Korean Traditional Music (Composition)	Sheet music larger than 24 measures and played with using 3 or more Korean or native musical instruments * Applicants can enter Korean Traditional Composition major after the examination	
Korean Traditional Music (Theory)	Study plan (Korean or English translated) * Applicants can enter Korean Traditional Music Theory major after the examination.	

06

Selection Procedure

2) Graduate schools

- **Evaluation** : Document screening (No admission test and interview)
 - ※ Some department offices may conduct separate interviews autonomously
 - ※ See Admission Unit for the departments which require artwork
- 1) Engineering (Architecture and Civil Engineering): Portfolio
- 2) Physical Arts (Theatre and Film): Portfolio
- 3) Arts and Design: Painting or portfolio
- 4) Music and Physical Arts: Submit a video of applicant’s performance in CD or USB

< Details on artworks of College of Music>

Department	Major	Course	Assignment
Korean Tradition Music	Korean Musical History	PhD	1 essay related to Korean music
	Theory	Master	1 essay related to Korean music
Music	Accompaniment	Master	Submit performance video of all three pieces below (with CD) 1) 1 movement of L. v. Beethoven’s Piano Sonata (fast movement) 2) 1 song of opera aria 3) 1 song of German songs
		PhD	Submit performance video of all three pieces below (with CD) 1) 1 movement of L. v. Beethoven’s Piano Sonata (fast movement) 2) Violin Sonata of C. Frank (Whole movements) 3) Each of 1 France, Britain and the US, and German songs
	Composition	Master and PhD	1. Submit 3 pieces of sheet music composed with music expression of 'Korean traditional music', 'Western classical music' or 'contemporary music' 2. Applicant can submit any of additional music file or video
	Piano	Master	Submit performance video of all two pieces below (with CD) 1) 1 song from L. v. Beethoven’s Sonata (Select two movement) 2) 1 song from Romanticism or 20th century music (around 10 minutes)
		PhD	Video CD of solo program which includes music of at least 3 periods (around 50 minutes)
	Western Musical History	Master	1 essay related to Western musical history (must be translated with Korean or English)
		PhD	1 essay related to Western musical history (must be translated with Korean or English)
	Western Music Theory	Master	1 essay related to Western music theory (must be translated with Korean or English)
		PhD	A master’s thesis or 1 essay related to Western music theory (must be translated with Korean or English)
	Organ	Master	Submit performance video of all two pieces below (with CD) 1) 1 song of J. S. Bach’s music (more than 10 minutes) 2) 1 song of the applicant’s choice (more than 10 minutes)
		PhD	Submit 50 minutes performance video including all three pieces below (with CD) 1) 1 song among the music earlier than J. S. Bach era 2) 1 song from J. S. Bach’ pieces 3) 1 song from Romanticism music
	Electronic Music Composition	Master and PhD	1. Submit 2 pieces of sheet music composed with music expression of 'Korean traditional music', 'Western classical music' or 'contemporary music' 2. Applicant can submit any of additional music file or video 3. Short piece of electronic music less than 3minutes (optional)
	Electronic Music Composition	Master and PhD	1. Submit portfolio that can show the ability with electronical music, recording, music production, or music software skill (free form) 2. Only officially released CD is possible (optional)

07

Admission Test (Undergraduate only)

Only undergraduate applicants are required to take the admission test, and will be proceeded simultaneously in Korea and China. Applicants who fail to take the test will automatically be dropped from admission. Applicants who live in Korea should take the test in Hanyang University and applicants who live in China should take the test in Shanghai or Beijing. Foreign applicants residing abroad, except for China, Hong Kong, Taiwan and Japan, must have an online face-to-face interview substituting for the admission test. Applicants who fail to attend the video interview will automatically be dropped from admission.

- 1) Exam type : Essay examination
- 2) Exam date : Please see application schedule. (The dates are tentative and will be announced on OIA website
 - <http://study.hanyang.ac.kr>)
- 3) Exam venue : Hanyang University (Details are to be announced)
- 4) What to bring : test ID slip, writing tools, passport or identification card (Identification with your photo)
- 5) Questions will be given in Korean, English, Chinese, Japanese and Mongolian.
- 6) Choose one language among Korean, English, Chinese, Japanese, German, French, Mongolian, Arabic, Vietnamese and Russian to answer the questions.
 - Students applying for International Studies must write in English
 - No additional marks will be given to the answers written in Korean.
- 7) Important!
 - Those who do not participate in admission test will automatically fail for admission.
 - ※ Foreign applicants residing in China can take admission and Korean test at designated test venues in China (Inquiries: www.hanyangdaxue.com, Tel: 86-21-51697003)

08

HYU Korean Language Proficiency Standard

Satisfying Korean standards is irrelevant to the admission to undergraduate and graduate schools. Nonetheless, students who have passed the admission test but failed the Korean Language Proficiency Test must take a leave of absence (maximum of 2 years) and take Korean language courses at either Hanyang University Institute of International Education or language institutes of other universities. By satisfying Korean standards of our university, students can re-register for upcoming school semester.

Course	Campus	Korean standards
Undergraduate school	Seoul Campus	1. Applicants who have TOPIK level 4 and higher 2. Applicants who completed Korean language course of Hanyang University level 5 and higher 3. Applicants who pass the Hanyang university Korean test (see Hanyang University Korean test information below)
	ERICA Campus	1. Applicants who have TOPIK level 3 and higher 2. Applicants who completed Korean language course of Hanyang University level 4 and higher 3. Applicants who pass the Hanyang university Korean test (see Hanyang University Korean test information below)
Graduate school	Seoul and ERICA Campus	1. Applicants who have TOPIK level 4 and higher 2. Applicants who completed Korean language course of Hanyang University level 5 and higher 3. Applicants who pass the Hanyang university Korean test (see Hanyang University Korean test information below) 4. Applicants who received bachelor's or master's degree from Korean university 5. Applicants who submit a letter requesting test exemption from their academic supervisor at Hanyang University

* Hanyang University Korean test information

- Every applicant who is not exempted the category below should take Korean test.
- <Applicants who are exempted from taking Korean test>
 - Students applying for the International Studies (Undergraduate applicant only)
 - Students applying for the English track of graduate school
 - Applicants who satisfy Korean standards of Hanyang university
 - Korean government-sponsored student (KGSP) and foreign government-sponsored students
- Exam date: Please see Application Schedule. (The dates are tentative and will be announced on office of international affairs webpage.)
- Exam venue: Hanyang University (specific venue to be announced later)
- What to bring: test ID slip, writing tools, passport or identification card

09

Dual application for students applying for undergraduate program

Students who are applying for undergraduate course can apply for both Seoul campus and ERICA campus.

1) Criteria

- ① Students who applied for Seoul campus for the first choice can also apply for ERICA campus as the second choice.
- ② Students who applied for ERICA campus for the first choice cannot apply for Seoul campus or other departments in ERICA campus.

Contents		Campus	
		Seoul	ERICA
Dual application		1 st choice	2 nd choice
Single application	Only Seoul campus	1 st choice	-
	Only ERICA campus	-	1 st choice

2) How to dual apply for campuses

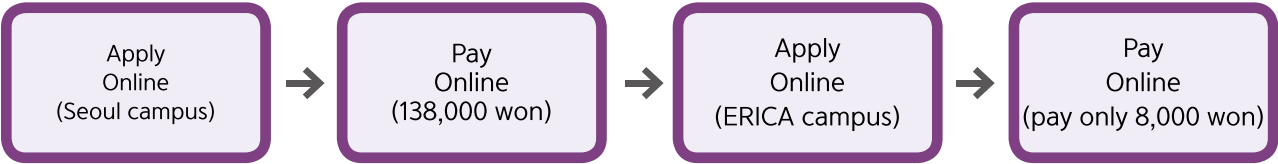

* Applicants who want to apply for both campuses must apply online twice. You can apply for ERICA campus after applying for Seoul campus. If you do not pay for the application, you cannot submit another application form.

3) The process of selection

Applicants will go through a screening process which will determine their eligibility based on an evaluation of the documents they have submitted and the results of their admission test. Applicants will take the admission test only once and those who do not get admission at the Seoul campus will automatically become candidates for admission at ERICA campus.

4) Results and registration

You can check the result at our website by entering your birth date and application number. Those who applied for both campuses should check the results for both campuses. Those who received admission at Seoul campus as the first choice must register for the Seoul campus.

10

Dormitories (This dorm fee is subject to change according to university policy)

1) Dorms in Seoul campus

Type	Gender	Name of dorm	Room type	Fee (6 months)	Note
On-campus	Male	Techno	Room for 2	About KRW 700,000 ~ KRW 2,300,000	※ Fixture and facility in room: closet, desk, bookshelf, chair, air conditioner ※ In case of 1+3 room, there are 2 rooms and one is for single bed and another is for triple bed.
			Room for 3		
			Room for 4 (consist of room for 1+3)		
	Female	Residence hall 1	Room for 4		
			Room for 1		
			Room for 2		
Off-campus	Male	Smartville	Hannuri hall	About KRW 2,300,000 ~ KRW 3,700,000	※ Fixture and facility in room: closet, desk, bookshelf, chair, air conditioner
			Gaenari hall		
			Room for 1		
			Room for 2		
			Room for 3		
	Female	Eaton house	Room for 1 (Standard)		
			Room for 1 (Superior)		
			Room for 2 (Standard)		
			Room for 2 (Superior)		
			Room for 2 (Deluxe)		
		Roseville	Room for 1 (Standard)		
			Room for 2 (Standard)		
			Room for 2 (Superior)		
			Room for 2 (Standard)		
			Room for 2 (Standard)		

<Contact>

Office	Website	Phone
Seoul Student Residence hall	http://eng.dormitory.hanyang.ac.kr/ [Address] 1F Residence Hall Administration Team, Student Residence Hall No.2, Hanyang University 222, Wangsimni-ro, Seongdong-gu, Seoul, Korea (04763)	82-2-2220-1471~2

2) Dorms in ERICA campus

Type	Name of dorm	Room type	Fee (6 months)	Note
On-campus	Injae #3	Room for 1	About 1,100,000 KRW ~ 2,600,000 KRW	One-room type
		Room for 2		Common facilities
	Changui hall	Room for 1		One-room type
		Room for 2		One-room type
	Happy residence hall	Room for 2		One-room type

<Contact>

Office	Website	Phone
ERICA Residence hall	http://hydorm.hanyang.ac.kr/ [Address] Hanyang University ERICA Campus Residence Hall, Hanyang University-ro, Sangrok-gu, Ansan, Gyeonggi-do, Korea (15588)	82-31-400-4374~9

11

Graduation Requirement

- Foreign Undergraduate students need to submit TOPIK level 4 and higher in order to graduate. (Excluding the International Studies department)
- Regardless of admission period (spring or fall semester), freshmen need to finish 8 semesters and transfer students need to finish 4 semesters to graduate. (However, those who registered for early graduation and meet the early graduation requirements are allowed to graduate early.)
- Please visit the department office for other graduation requirements and graduation credits.

12

Admission Inquiries and Document Submission

Office	Email	Website	Phone	Fax
Office of International Affairs (Admission)	intladms@hanyang.ac.kr	study.hanyang.ac.kr	82-2-2220-2444~2451	82-2-2220-1798
Office of International Affairs, Room 218, International Building, Hanyang University 222 Wangsimni-ro, Seongdong-gu, Seoul (04763), Republic of Korea				



13

Scholarships for International Students

Type	Scholarship and contents	Subject		Application period
		Under-graduate	Graduate	
For newly admitted students	▶ Hanyang International Scholarship Program (HISP) – Undergraduate HISP grantees are evaluated and selected based on scholastic achievement at their admission test (face interview) or artwork (portfolio) among undergraduate applicants who are eligible to apply for the HISP. <ul style="list-style-type: none">• Qualification: Applicants who take the admission test (face interview) or submit their artwork (portfolio)• Benefits: 100%, 70% or 50% reduction in tuition• Scholarship period: Freshman 8 semesters / Transfer 4 semesters ※ The number of grantees may differ every semester. ※ Requirement: Scholarship recipients must achieve a minimum 2.0 GPA each semester in order to retain their scholarship.	●		Apply while applying for admission
	▶ Hanyang International Scholarship Program (HISP) – Graduate HISP grantees are evaluated and selected based on scholastic achievement at their previously attended institution among graduate applicants who are eligible to apply for the HISP. <ul style="list-style-type: none">• Qualification: GPA from the previously attended institution must be 80 or higher when converted to a 100 scale• Benefits: 100%, 70% or 50% reduction in tuition• Scholarship period: Master 4 semesters / PhD 8 semesters including research registration and excluding extended study period ※ The number of grantees may differ every semester. ※ Requirement: Scholarship recipients must achieve a minimum 2.0 GPA each semester in order to retain their scholarship.		●	Apply while applying for admission
	▶ Hanyang Scholarship for Excellence in Language Proficiency Hanyang Scholarship for Excellence in Language Proficiency is awarded to applicants who have passed the TOPIK level 5 or 6, or achieved a TOEFL IBT score of 90 or higher or IELTS score of 6.5 or higher. (Only documents submitted during the official application period are acceptable.) <ul style="list-style-type: none">• Benefits: 30% reduction in tuition• Scholarship period: The first semester only ※ TOEFL score is not applicable to native speakers of English.	●	●	Selected after admission (no need to apply)
	▶ Hanyang Scholarship for Engineering and Science Students Hanyang Scholarship for Engineering and Science Students is awarded to international students who gain admission to the graduate school of engineering and science and are recommended by a professor at Hanyang University. (It is not necessary for applicants to submit a letter of recommendation.) <ul style="list-style-type: none">• Benefits: 50% reduction in tuition and admission fees• Scholarship period: Four semesters• Requirement: Scholarship recipients must achieve a minimum 2.0 GPA each semester in order to retain their scholarship.		●	Selected after admission (no need to apply)
	▶ GSIS and GSIC Scholarship for International Students GSIS and GSIC scholarships are awarded to international students who gain admission to the Graduate School of International Studies(GSIS) and Graduate School of Industrial Convergence(GSIC). <ul style="list-style-type: none">• Benefits: 50% of reduction in tuition• Scholarship period: Four semesters for GSIS, Five semesters for GSIC		●	Selected after admission (no need to apply)
	▶ MBA Scholarship for International Students Scholarship is awarded to selected students among international students based on their academic performance and financial need. <ul style="list-style-type: none">• Benefits: Amounts of the scholarships will be based on academic performance and financial need• Scholarship period: One semester (Scholarship recipients will be selected each semester)		●	Selected after admission (no need to apply)
	▶ Scholarship for combined Master's and Doctoral program in Engineering and Science Recipients are selected among combined Master's and Doctoral program students who receive a 50% tuition waiver scholarship for Engineering and Science. <ul style="list-style-type: none">• Benefits: Full amount of tuition fee• Scholarship period: Six semesters• Requirement: Scholarship recipients must achieve a minimum 3.75 GPA each semester and have two or three papers published in SCI(E) journals in order to retain their scholarship		●	Selected after admission (no need to apply)
For registered students	▶ Hanyang International Excellence Awards (HIEA) HIEA is awarded to international students who have achieved notable academic progress at Hanyang University. <ul style="list-style-type: none">• Qualification: Students with valid TOPIK level certificate and Insurance who achieved a minimum GPA of 3.0 the previous semester• Recipients are selected by paper screening. Recipients will receive 70%, 50% or 30% tuition reduction according to their evaluation results.• Scholarship period: One semester	●	●	Apply during semester
	▶ TOPIK Scholarship Foreign student who is currently enrolled for a degree program and obtained TOPIK certificate after the time of admission is eligible. Student who is on a leave of absence OR extended his/her study in undergraduate/graduate level is excluded. <ul style="list-style-type: none">• Benefits: Admission fee will be provided regardless of the result of examination. Applicants must register for the higher level than their former level obtained. Beginner level is not included.• Scholarship: The scholarship will be provided in the case of acquirement of higher level certificate. Level 6 holder can be benefited in the case of their certificates are already expired or having less than 5 months to the expiration date of their certificates.• Application Documents:<ul style="list-style-type: none">① Before test: the test identification② After test: TOPIK certificate, copy of a bank account, TOPIK certificate obtained before (only for holder)	●	●	Apply during semester

14

Tuition Fee Chart (This is 2018 Standard and tuition fee is subject to change according to university policy)

▶ General Graduate School				KRW(₩) / per semester
College/School	Tuition	Admission Fee	Fields	
Humanities/ Social Sciences	5,322,000	1,030,000	Humanities, Social Sciences, Law, Economics and Finance, Business Administration, Education(excluding Applied Art), Theater and Film, Interdisciplinary Courses(Early Childhood Education, Digital Culture Contents, Museum Education, Mass Media and Scenario Contents), International Culture(ERICA), Communication and Social Sciences(ERICA), Economics and Business Administration(ERICA)	
Physical Science/ Physical Education	6,270,000	1,030,000	Nursing, Natural Sciences, Human Ecology, Interdisciplinary Courses(Health Management, Child Psychotherapy, New Drug Development, Convergence Nanoscience), Science and Technology(ERICA), Physical Education, Global Sports Industry and Management (ERICA), Sports and Well-being (ERICA)	
Engineering	7,126,000	1,030,000	Engineering, Interdisciplinary courses(Urban and Real Estate Development, Information Display Engineering, Intelligent Robotics, Nanoscale Semiconductor Engineering, Engineering Sciences(ERICA), Computing(ERICA)	
Fine Arts	7,294,000	1,030,000	Dance, Applied Art, Design(ERICA), Living Dance and Performing Art(ERICA)	
Music	7,294,000	1,030,000	Music	
Medicine	8,303,000	1,030,000	Medicine	
Pharmacy	7,401,000	1,030,000	Pharmacy	

▶ Professional Graduate School/Specialized Graduate School				KRW(₩) / per semester
College/School	Tuition	Admission Fee	Fields	
International Studies	6,196,000	1,030,000	Russian Studies, American Studies (English Track), Chinese Studies, Korean Studies, Korean Language Education – Korean Studies, Global Social Economy Studies	
MBA	9,052,000	1,030,000	Global YES MBA (Young Entrepreneur Spirit), Korea and Asia Business Studies MBA (English Track), Global Business Management MBA, Hanyang MBA, Digital Business MBA, Finance MBA, Arts, Culture & Entertainment MBA, Healthcare Management MBA, Strategic Project Management MBA	
Biomedical Science and Engineering	7,123,000	1,030,000	Biomedical Engineering, Biomedical Science, Translation Medical Science, Biomedical Informatics	
Urban Studies	6,513,000 (Urban Development and Management, Real Estate: 6,196,000)	1,030,000	Urban development and management, Urban regeneration and design, Landscape urbanism	
International Tourism	5,306,000	1,030,000	Tourism & Hospitality Administration, Convergence Tourism, Culture-entertainmnet Tourism	
Technology & Innovation Management	8,505,000	1,030,000	Technology Management	
Journalism and Mass Communication	5,306,000	1,030,000	Newspaper, Magazine & Publishing, Advertising and Public Relations, Broadcasting & Visual Communication, Digital Media	
Public Policy	5,228,000	1,030,000	Public Administration, Local Autonomy, Healthcare Administration, Social Welfare, Civil Society, Legal Affairs	
Industrial Convergence	5,306,000 (Design: 6,236,000)	1,030,000	Business Administration, Design, Culture Contents, Performing Arts Management	

▶ Undergraduate School				KRW(₩) / per semester
College/School	Tuition	Admission Fee	Fields	
Humanities/ Social Sciences	3,872,000	820,000	Humanities, Social Sciences, Policy Sciences, Economics and Finance, Business Administration, International Studies, International Culture(ERICA), Communication and Social Sciences(ERICA), Economics and Business Administration(ERICA)	
Physical Science/ Physical Education	4,510,000	820,000	Natural Sciences, Human Ecology, Fine arts and Physical Education (Physical Education, Sport Industry and Management), Science and Technology(ERICA), Sports and Arts(Sports Science (ERICA)	
Engineering	5,104,000	820,000	Engineering, Engineering Sciences(ERICA), Computing(ERICA)	
Fine Arts	5,116,000	820,000	Fine arts and Physical Education(Film and Theater, Dance), Design(ERICA), Sports and Arts(Dance and Performing Art(ERICA)	
Music	5,735,000	820,000	Music, Sports and Arts (Applied Music)	

* This guideline is originally written in Korean and translated in other languages. The Korean guideline prevails over translated versions in case of any conflict over the interpretation of this guideline.

The Engine of Korea

HANYANG UNIVERSITY

Like the bell that rings out from Hanyang's belfry,
Hanyang University is committed to spreading hope to society
through education.





HANYANG

From the driving force of Korea
to a world-class educational institution

#1 Nature Index 2017 in nation

#3 Seoul Campus, #9 ERICA campus:
2017 JoongAngIlbo(daily) University Rankings

#1 2017 Engineering School Assessment by
The Korea Economic Daily and Global Research

#1 No. of CEOs from Hanyang University in 2017
(10,177 CEOs)

#1 No. of start-ups in nation in 2017 (2,266 start-ups)

#155 2017 QS world University Rankings



HANYANG UNIVERSITY

Office of International Affairs #218, International building, Hanyang University,
222 Wangsimni-ro, Seongdong-gu, Seoul 04763, Korea

Tel. +82-2-2220-2444~2451, Fax. +82-2-2220-1798

Email. intladms@hanyang.ac.kr

Website. <http://study.hanyang.ac.kr>